

ガラス封止UV-LED

Glass-UV LED

Glass UV

Pb Free

Pb Free HEAT

RoHS

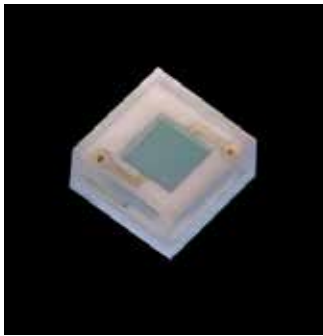

構造/ Structure

オール無機材料

All inorganic material

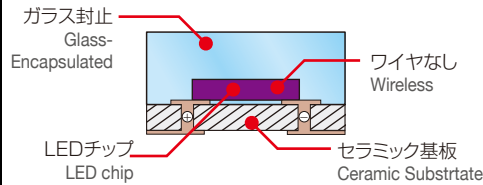

外形寸法/ Package Outlines

(Unit: mm)

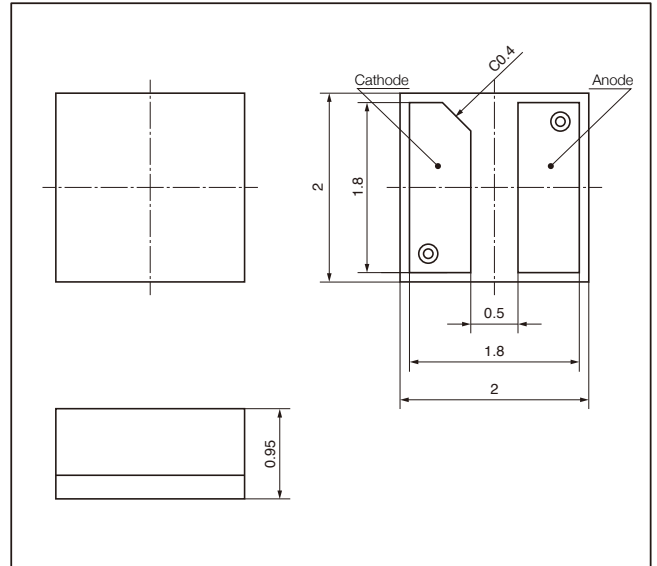

基本特性/ Basic Characteristics

ピーク波長 Peak Wavelength	光出力 Power	順電圧 Forward Voltage
405nm	880mW	3.50V
395nm	840mW	3.60V
385nm	800mW	3.65V

IF=500mA

特徴/ Characters

狭面積内に異なる波長で複数実装可能

Capable of Multi-wavelength submount in narrow area

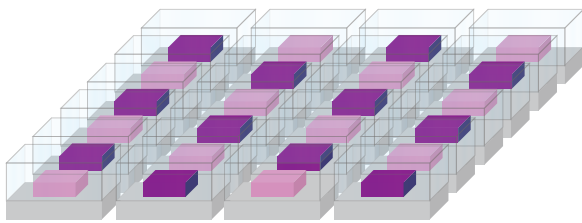

光取り出し効率向上

Enhanced light extraction efficiency



当社製品
Glass UV

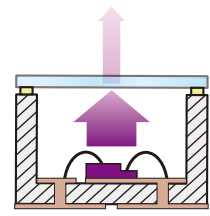

従来品
Conventional product

超小型サイズ (従来品 1PKG ≒ 4PKG)

Small sized package (4pcs glass ≒ 1pc of conventional product)

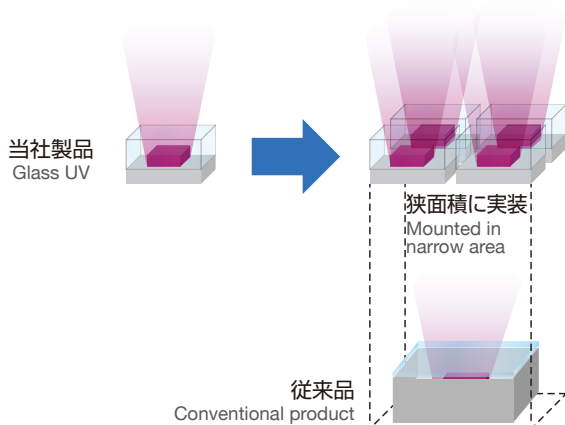

外気の影響を受けず4万時間以上の長寿命

Long life (over 40KH) with outer air block

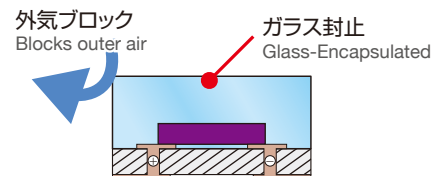

高温通電試験 (100°C, 500mA)
High Temperature Test

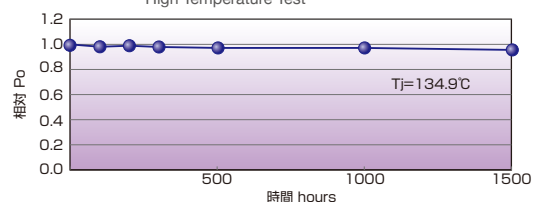

指向特性/ Directive Characteristics

(Ta=25°C)

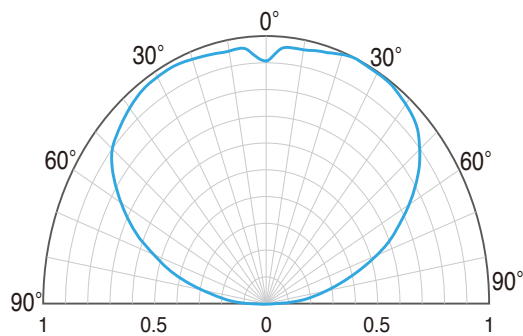

代表的特性/ Typical Characteristics

(Ta=25°C)

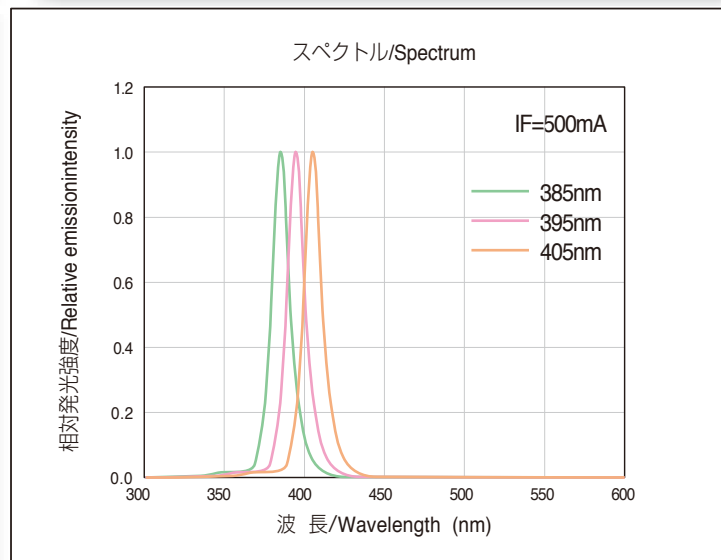
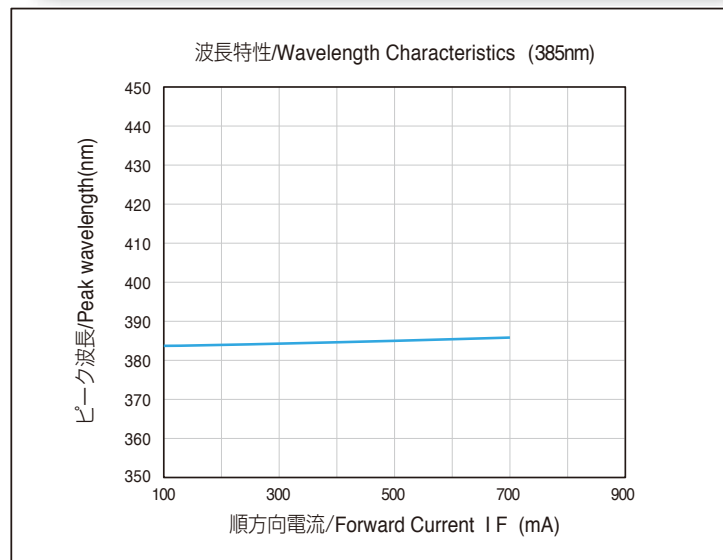
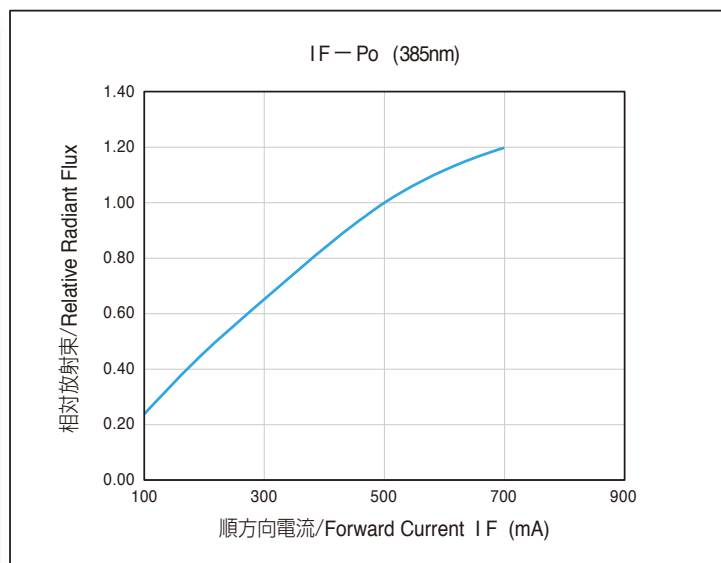
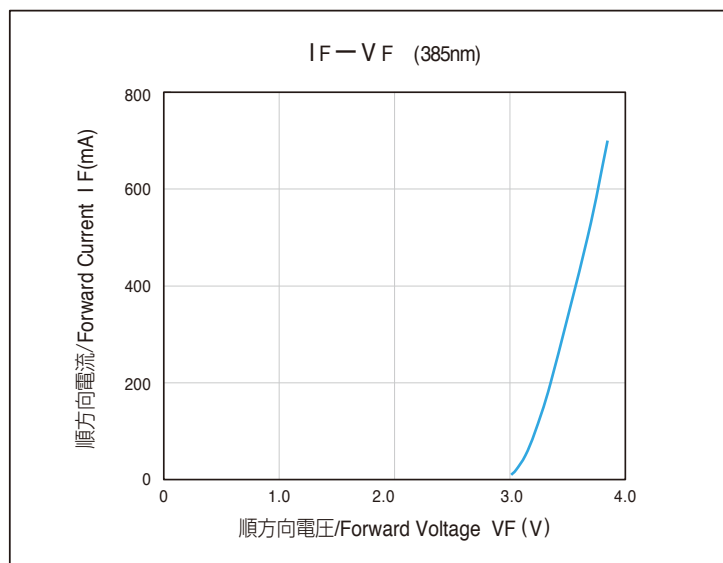

*本製品の仕様及び外形は、改良などのため予告なしに変更することがあります。
* Modifications in the shape and specifications of a Product be made without prior notice.

*本項のデータは代表値です。
* The data shows typical value.

*詳細については下記の営業窓口にお問い合わせください。
* For details on the Products described here, kindly contact the Optoelectronics Sales Division.



TOYODA GOSEI

豊田合成株式会社

オプトE営業部
〒490-1207 愛知県あま市二ツ寺東高須賀1番地1
TEL.052-449-5673 FAX.052-449-5732
(担当: 桂川)

TOYODA GOSEI CO., LTD.

Optoelectronics Sales Division
Phone: +81-52-449-5673 Facsimile: +81-52-449-5732
1-1, Higashitakasuga, Futatadera, Miwa-cho, Ama, Aichi 490-1207, JAPAN
(PIC: Katsuragawa)